

**CONTRACT
140**

Chas. Skinner

Legal Description:
Snyder:
Lots 5

Section 15
Township 10 South
Range 17 East

Legend

- Man Holes
- Observation Wells
- Tunnel Portals
- Vertical Shafts
- Wells
- Drains
- Tunnels
- City Limits
- Canals
- Roads
- Section Line
- Parcels



This map is for informational and reference purposes only and may not have been prepared for, or be suitable for legal, engineering, or surveying purposes. Users of this information should review or consult the primary data, and information sources to ascertain the usability of information.

AGREEMENT

WELL DRAINAGE

TWIN FALLS CANAL COMPANY,

Party of the First Part.

Chas W Skinner

Party of the Second Part.

Sec. 15 Tp. 10 R. 17

July 1 1919

*Lat 5 Snyder tract
1 acre*

*North of Stearns,
Completed*

AGREEMENT

This Agreement, Made this 1st day of Feb 1919

by and between the TWIN FALLS CANAL COMPANY, an Idaho corporation,
party of the first part, and Chas W Skinner

party of the second part, witnesseth:

Whereas, the following described land, to-wit: Lot F, Snyder
tract

in Twin Falls County, Idaho, is at present being injured by seepage; and, whereas, the first party is about to bore one or more wells on or near said land under the direction of _____, a drainage engineer, for the purpose of determining the effect of such wells in draining said seeped land;

Now therefore, in consideration of the premises, it is hereby agreed:

(1) That the first party may at its option and under the direction of said engineer bore one or more wells on or near said land, the number, size, depth, character, and location to be designated by said engineer, that the first party shall have the right to enter on said lands and do and perform any and all things reasonably necessary in the judgment of said engineer in the furtherance of said work.

(2) The cost of boring said wells shall in the first instance be borne by the first party; but, the second party agrees to reimburse the first party to the extent of Fifteen dollars (\$ 15.00) per acre for any and all lands drained, the number of acres, if any, to be determined by the said engineer.

(3) It is understood that the first party does not in any wise admit or acknowledge that the seepage hereinbefore referred to or any part thereof, is the result of any neglect or other act or omission on the part of the first party, or that it is in any wise responsible for same, or that the first party in any wise admits or acknowledges a liability on account of same, or liability or responsibility to install the said or any system of drainage, or the right to second party to damage.

(4) It should be understood that should a flow of water be obtained by reason of said well, the same shall be subject to the use of the first party for irrigation, and second party will grant to the first party a free easement and right of way for ditches or waterways necessary to carry said water to the place or places desired by first party in order to utilize or dispose of same.

In Witness Whereof, the first party has caused the same to be executed by the hand of its secretary; and, the second party has set _____ hand the day and year first above written.

TWIN FALLS CANAL COMPANY,

By _____ Secretary

Chas W Skinner

Chas W. Skinner

Cont # 140

Lot "F" Snyder Tract.

Sec. 15 - 10 - 17

Owned by Oscar House

The vegetation is good on this lot except a very small strip at the East end. This area shows some alkali but no moisture down to the shale or rock which is only 2' 6" below the surface.

The land is drained at this time of the season.

This lot has an 8" tile drain across the west end as shown on the blue print.

1 acre affected

July 30, 1920
L. H. Perrine

Re: Chas. W. Skinner. Drainage Contract # 140.

Lot "F" Snyder tract section 15-10-17 has a tile line thru it. Looks good at this time. Can not ascertain whether drainage is complete until after another normal water year.

Oct. 10, 1919.

O. House

PLAT
OF
SNYDER TRACT

SCALE 1" = 100 FT

1" = 150'

N 1/2 of SE 1/4 Sec 15-10^s-17^E B.M.

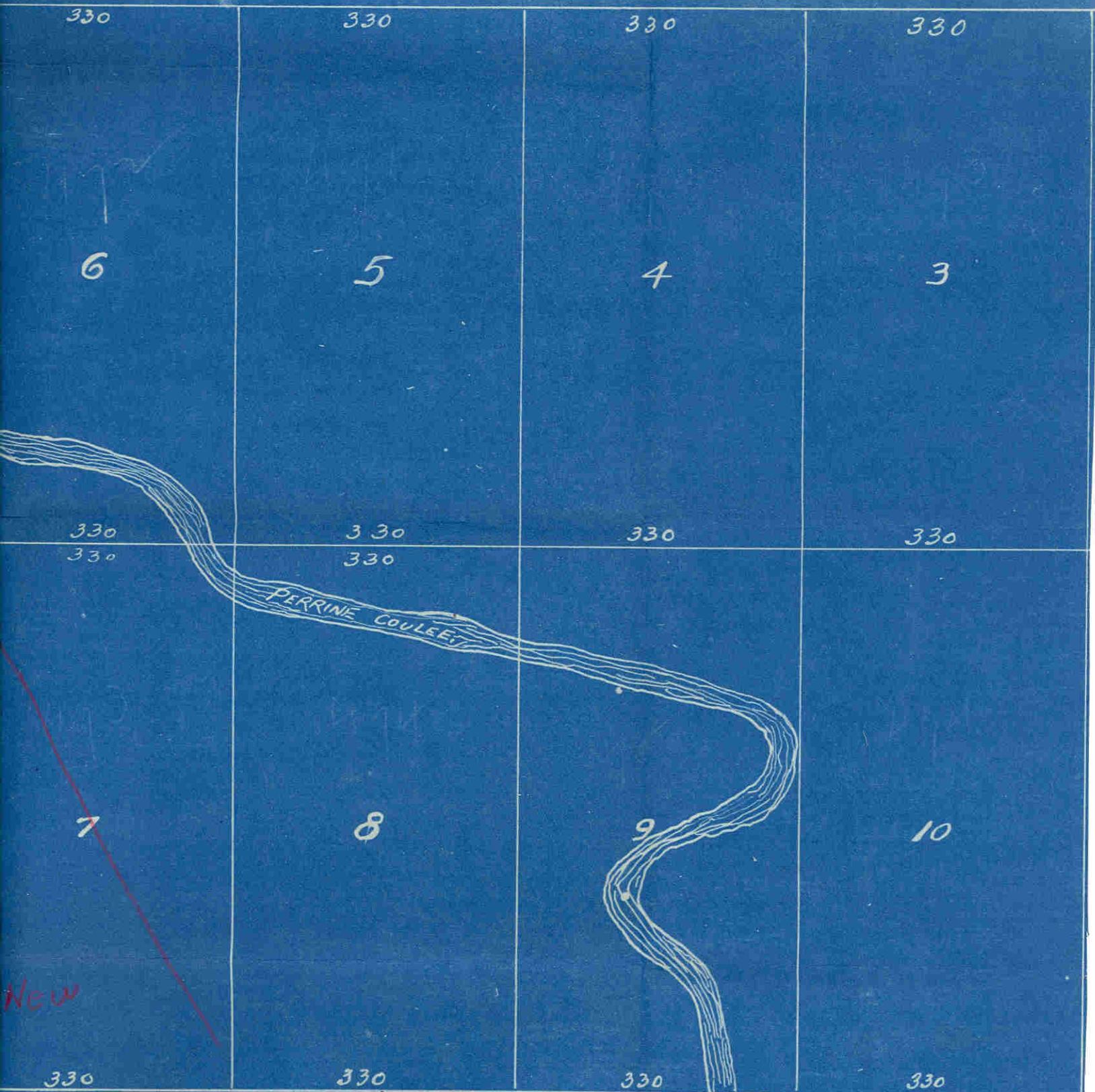

SNM

N 1/2 05 SE 1/4

Cor. of Sec.

